

FLOW-THROUGH CHAMBER FOR GASES

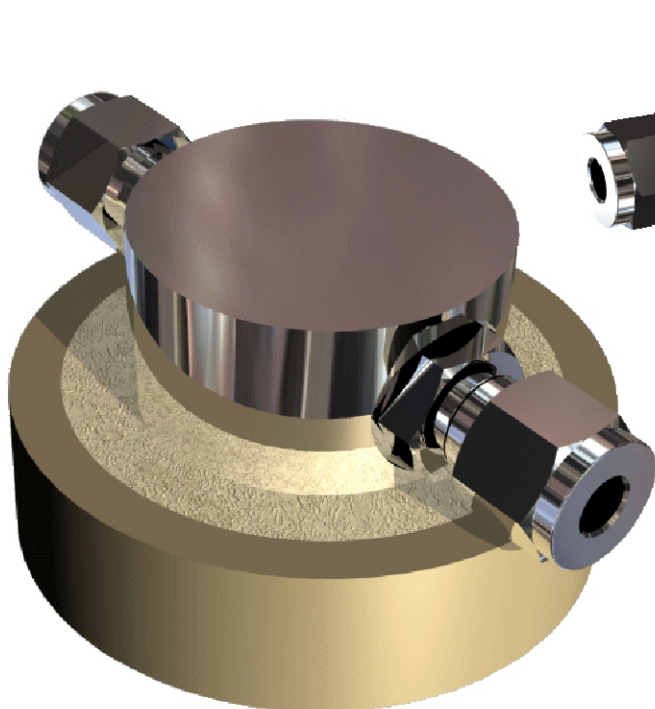

CLOSED CHAMBER VIEW



EXPLODED CHAMBER VIEW

The measurement chamber can be fixed on its base by means of 4 Stainless Steel M4 screws, it can be arranged in two different positions, in this way it is possible to work both with a gas parallel flow gas as with a gas perpendicular flow, these directions are referred to the quartz crystal surfaces. This cell has been designed to work with 8mm (0.315 inch) quartz crystal.

Chamber type ⁽¹⁾	: Flow-Through chamber for gases
Geometric Shape:	: Cylindric
Flow Direction:	: Parallel /Perpendicular
Size (referred to the internal volume)	: 16.5 mm (∅) x 15 mm (h)
Employed materials ⁽²⁾	: Teflon, AISI316 Stainless Steel
Weight	: 0.280 Kg
Chamber internal volume	: 3.2 cc
Quartz diameter	: 8 mm
Oring used	: 1 piece
Oring material	: Viton
I/O Gas Connectors:	: Swagelok 1/4 inch

⁽¹⁾ other chambers available (for gas, flow-through, custom chambers, etc.)

⁽²⁾ other materials available

ADDRESS: BIOAGE s.r.l.
Via Trento, 77
IT-88046
Lamezia Terme
(CZ) ITALY

TEL: (+39) 0968 51061
MOBILE: (+39) 349 3564443

WEBSITE:
www.bioage-srl.com

EMAIL:
info@bioage-srl.com
research@bioage-srl.com
quotation@bioage-srl.com
services@bioage-srl.com

